



Similar to illustration

### Chamber Furnace **KU 40/75**

⊕	Volume	<b>40 litres</b>
⊙	Int. dimensions (w x d x h)	<b>300 x 400 x 300 mm</b>
⊞	Power	<b>5.2 kW</b>

## Technical data

### ☰ Overview

Product group	<b>Kiln</b>
Design	<b>Chamber Furnace</b>
Type	<b>KU series</b>

### ⏻ Energy

Energy type	<b>Electrical</b>
Power	<b>5.2 kW</b>
Supply	<b>12.1 A</b>
Voltage	<b>3/N/PE 400V AC</b>
Connection	<b>CEE 16 A</b>

### ⊕ Dimensions

Volume	<b>40 litres</b>
Int. dimensions (w x d x h)	<b>300 x 400 x 300 mm</b>
Ext. dimensions (W x D x H)	<b>715 x 1165 x 1450 mm</b>
Weight	<b>240 kg</b>

### ★ Equipment

Insulation	<b>2-layer, 120 mm</b>
Heating	<b>4-side</b>
Heating elements	<b>Tubular heating elements</b>
Control	<b>Jumo dTron</b>

## Besondere Merkmale

### Torsion-resistant welded steel housing

The housing consists of a torsion-resistant welded construction. Each furnace is manufactured by hand and leaves the factory after undergoing extensive quality controls.

### Durable textured paint finish

The high-quality light-grey RAL 7035 textured coating protects the furnace body and steel construction.

### Air circulation allows for high temperature uniformity

ROHDE-designed air circulating fans are decoupled from the drive motor and are quiet, durable and above all easy to service.

### Excellent temperature uniformity of $\pm 3\text{ K}$

Excellent temperature uniformity of  $\pm 3\text{ K}$  (according to DIN 17052) is achieved in the useful space by using powerful air circulation in the furnace interior.

### Robust swing door allows for safe opening

The convenient operation of the swing door allows easy opening of the furnace. The solid door handle ensures smooth operating procedures even when opening the hot furnace while the process is running.

### Flexible door sealing allows for thorough door closing

A flexible insulating cord ensures a seal between the door and the furnace opening. Minor unevenness can be corrected and the door can be closed flush with the furnace.

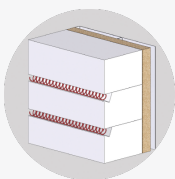

### Efficient 2-layer insulation structure

A sophisticated 2-layer insulation structure allows for required temperatures to be achieved using less energy. High energy efficiency can be achieved even in continuous use.

### Easy-to-maintain switchgear mounted in a Rittal switch cabinet

The switchgear is mounted in a Rittal switch cabinet and can be easily maintained and accessed.

### Low-wear contactors for control

The furnace is controlled by low-wear, durable contactors.

### **Precise temperature measurement with “Type K” thermocouple**

The installed NiCrNi thermocouple (type K) is protected against damage and guarantees exact temperature measurement at all times.



### **The “CEE 16 A” connector allows for easy connection**

The standardised CEE 16 A connector allows for easy connection and quick start-up.

### **Components from well-known manufacturers contribute to long service life**

We only obtain our electric components from well-known manufacturers (e.g. SIEMENS, MOELLER, WEIDMÜLLER, RITTAL).

### **Furnace construction in accordance with DIN EN 746-1**

The unit is constructed and manufactured in accordance with DIN EN 746-1 Industrial Thermoprocessing Equipment.

### **Switchgear design in accordance with DIN EN 60519**

The switchgear is designed in accordance with DIN EN 60519 Safety in Installations for Electroheating.

### **2-year warranty despite intense use**

We deliberately refuse to reduce the warranty period despite commercial furnaces being used intensely except parts that are subject to wear.